

## IGH Hydrostatic swing gearbox series

### 1. Brief Introduction

The IGH swing gearbox series are the ideal driving components for wheeled or crawler excavator, rotary drill rigs, crawler cranes and vehicle cranes, marine cranes and other mobile equipment. The series have proven their worth under arduous application conditions in the most unfavorable operating environments.

The series feature compact size, space-saving, high efficiency, long service life, integrated multiple-disk holding brake, simple mounting and maintenance. Module design and optimize gear manufacture and high quality fabrication processes ensure excellent load carrying ability and outstanding operational reliability.

The series described in this catalog are of the standard type. Other design variants with different ratio, dimensions and power characteristics are available if so requested for specific applications.

We can provide specific application consultation to customers aimed at finding the optimum drive configuration at the project stage.

The drives have been widely applied in wheeled or crawler excavators, crawler cranes, rotary drill rigs, marine cranes. The drives not only widely have been used by domestic customer such as SANY, XCMG, but also have been exported to Southeast Asia, Middle East, India, South Korea, Netherlands, Germany and Russia and so on.

### 2. Model Options

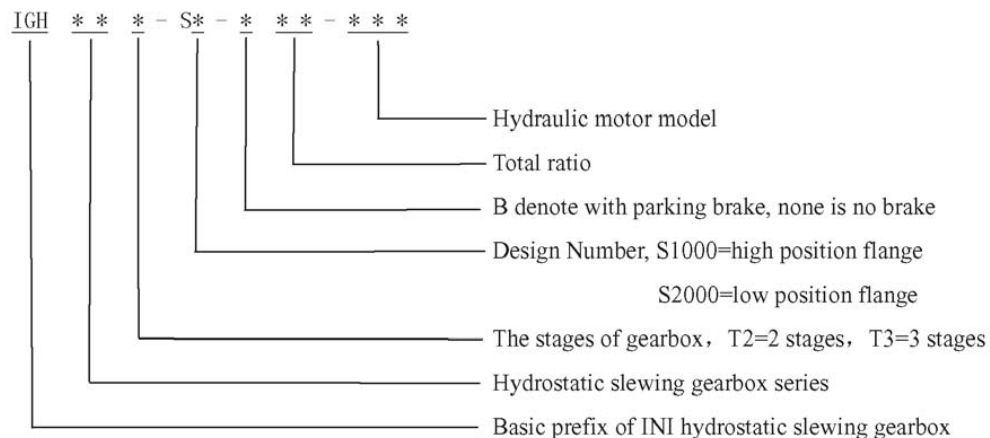

### 3. Options Example

IGH17T2-S1000-B27.4-A2FE56/61WVZL represents that the series swing gearbox is 17 with maximum output torque of 12.7kNm, high position flange, two stages planetary gearbox with a total ratio of 48 and a multi-disc parking brake, and could be fitted with axial piston hydraulic motor of A2FE56/61WVZL.

## 外形尺寸

### Dimensions

IGH17T2-S1000

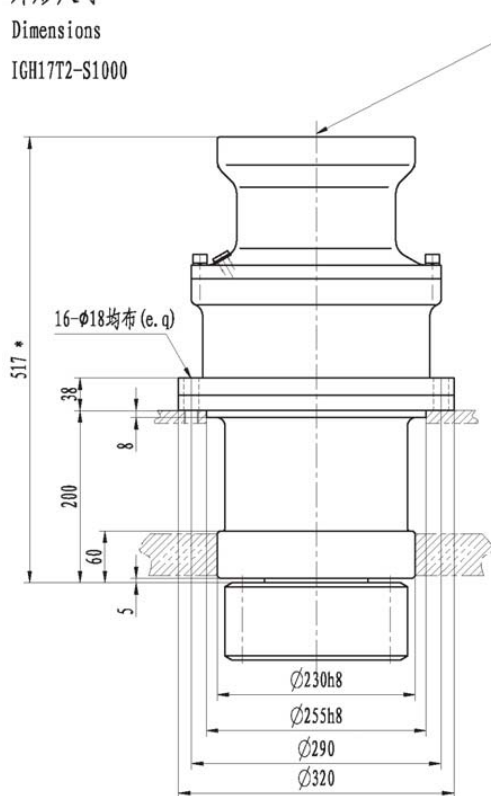

马达法兰连接面  
motor interface

IGH17T2-S2000

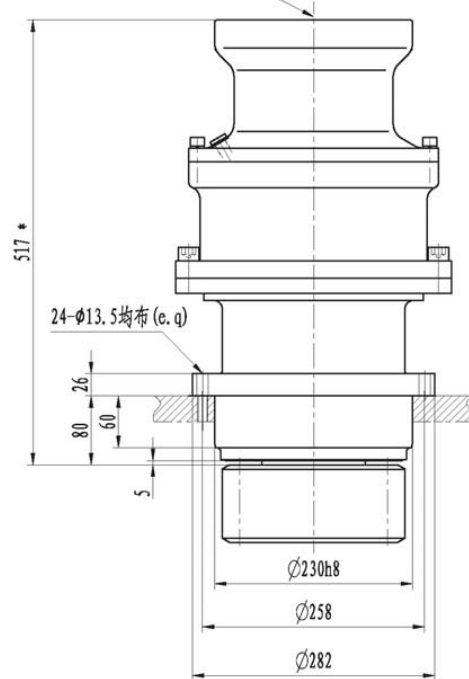

## 技术参数

### Technical Data

最大输出扭矩 Output Torque $T_{max}$ Nm	传动比 Ratio $i$	液压马达 Hydraulic Motor				重量 Weight ≈ kg
12700	27.4 · 33.1 · 38.6 · 46.4 · 55	A2FM45 A2FM55 A2FM63	A2FE45 A2FE56 A2FE63	H1CR45 H1CR55	HMF50 HMF55	130

· 减速机输入转向与输出转向相同,除表中所列传动比外,对有批量的产品传动比可以另选。  
 · Gearbox input direction is same to the output direction. Other ratio is optional.  
 · 该系列回转装置可根据用户需要选配不同形式的液压马达,并可根据实际工况组合各种功能阀块。  
 · Allowing fitted with different type motors and manifolds for relevant actual application.  
 · 根据应用场合不同,液压回转装置的使用选型也有所变化,详情请咨询本公司相关技术人员。  
 · Differently sized units and additional design variants can be furnished if requested.

## 外形尺寸

Dimensions

IGH17T3-S1000

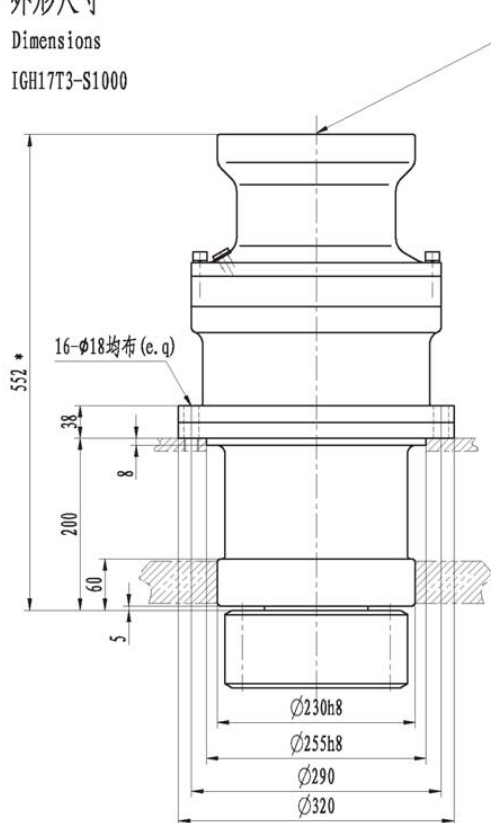

马达法兰连接面  
motor interface

IGH17T3-S2000

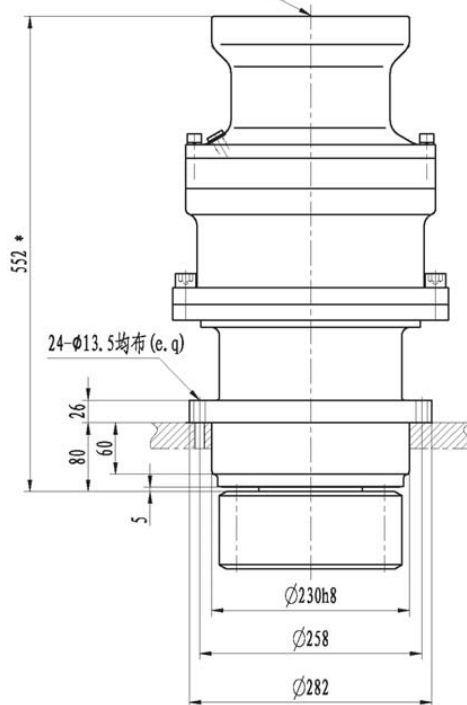

## 技术参数

Technical Data

最大输出扭矩 Output Torque $T_{max}$ Nm	传动比 Ratio $i$	液压马达 Hydraulic Motor				重量 Weight ≈ kg
12700	78.9 · 89.2 · 103.6	A2FM28	A2FE32	H1CR30	HMF28 HMF35	150
		A2FM45	A2FE45	H1CR45		
		A2FM55	A2FE56	H1CR55		

- 减速机输入转向与输出转向相同,除表中所列传动比外,对有批量的产品传动比可以另选。
- Gearbox input direction is same to the output direction. Other ratio is optional.
- 该系列回转装置可根据用户需要选配不同形式的液压马达,并可根据实际工况组合各种功能阀块。
- Allowing fitted with different type motors and manifolds for relevant actual application.
- 根据应用场合不同,液压回转装置的使用选型也有所变化,详情请咨询本公司相关技术人员。
- Differently sized units and additional design variants can be furnished if requested.

## 外形尺寸

Dimensions

IGH24T3-S1000

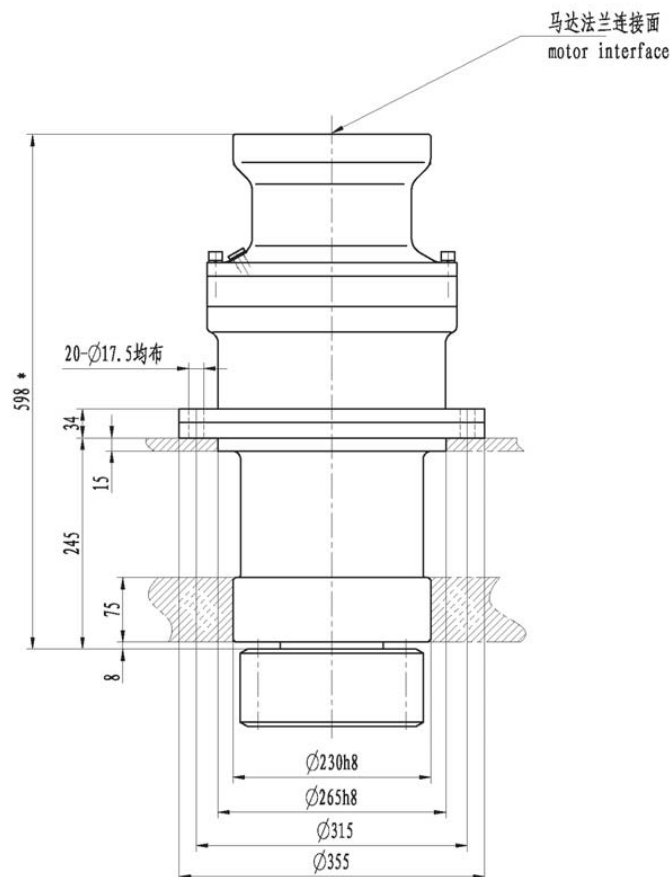

## 技术参数

Technical Data

最大输出扭矩 Output Torque $T_{max}$ Nm	传动比 Ratio $i$	液压马达 Hydraulic Motor				重量 Weight $\approx$ kg
17500	91.1 · 103.6 · 121.5 · 138.2	A2FM28 A2FM45 A2FM55	A2FE32 A2FE45 A2FE56	H1CR30 H1CR45 H1CR55	HMF28 HMF35	150
<ul style="list-style-type: none"> <li>· 减速机输入转向与输出转向相同,除表中所列传动比外,对有批量的产品传动比可以另选。</li> <li>· Gearbox input direction is same to the output direction. Other ratio is optional.</li> <li>· 该系列回转装置可根据用户需要选配不同形式的液压马达,并可根据实际工况组合各种功能阀块。</li> <li>· Allowing fitted with different type motors and manifolds for relevant actual application.</li> <li>· 根据应用场合不同,液压回转装置的使用选型也有所变化,详情请咨询本公司相关技术人员。</li> <li>· Differently sized units and additional design variants can be furnished if requested.</li> </ul>						

# 外形尺寸

Dimensions

IGH36T2-S1000

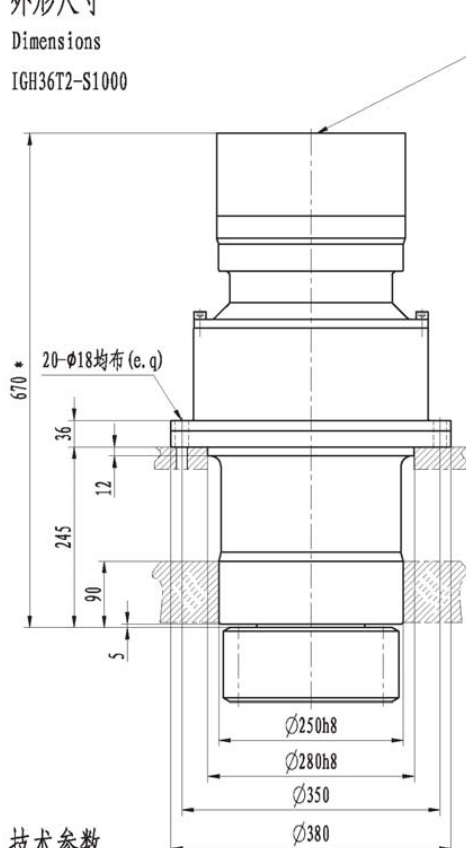

马达法兰连接面  
motor interface

IGH36T2-S2000

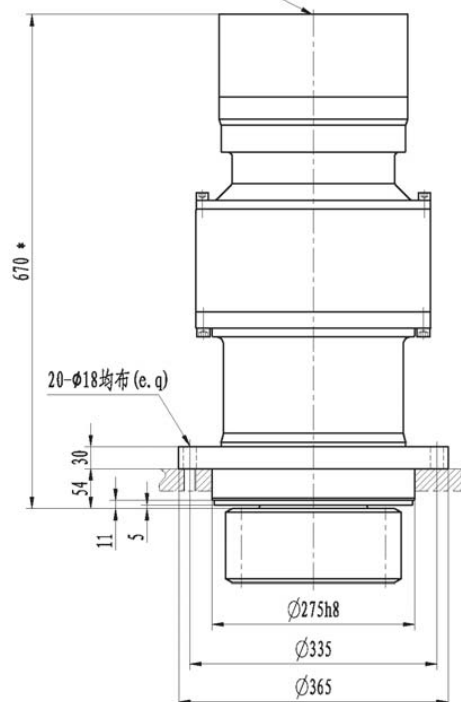

# 技术参数

Technical Data

最大输出扭矩 Output Torque $T_{max}$ Nm	传动比 Ratio $i$	液压马达 Hydraulic Motor				重量 Weight ≈ kg
28500	43.9 · 51.5 · 63 24 · 42.1 · 48.1	A2FM80	A2FE80	H1CR75	HMF75	210
		A2FM107	A2FE90	H1CR90	HMF105	
		A2FM125	A2FE107	H1CR108	HMF135	
			A2FE125			

- 减速机输入转向与输出转向相同,除表中所列传动比外,对有批量的产品传动比可以另选。
- Gearbox input direction is same to the output direction. Other ratio is optional.
- 该系列回转装置可根据用户需要选配不同形式的液压马达,并可根据实际工况组合各种功能阀块。
- Allowing fitted with different type motors and manifolds for relevant actual application.
- 根据应用场合不同,液压回转装置的使用选型也有所变化,详情请咨询本公司相关技术人员。
- Differently sized units and additional design variants can be furnished if requested.

## 外形尺寸

### Dimensions

IGH36T3-S1000

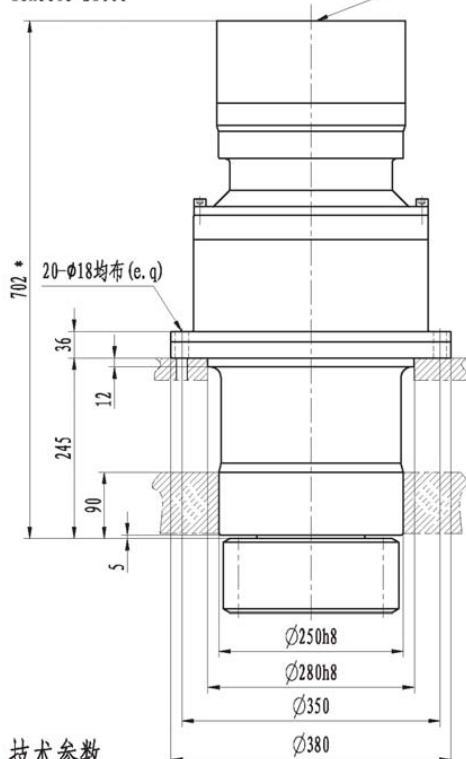

IGH36T3-S2000

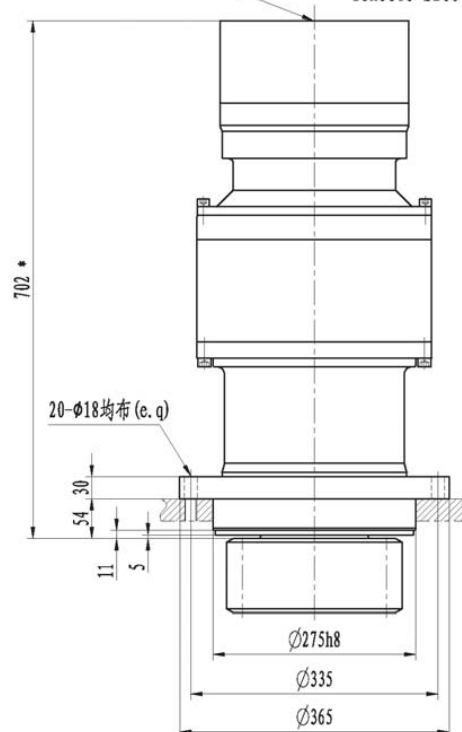

## 技术参数

### Technical Data

最大输出扭矩 Output Torque T <sub>max</sub> Nm	传动比 Ratio i	液压马达 Hydraulic Motor				重量 Weight ≈ kg
28500	68 · 80.4 · 101 · 117.6 · 131.4	A2FM55	A2FE56	H1CR55	HMF50	235
		A2FM63	A2FE63	H1CR75	HMF55	
		A2FM80	A2FE80	H1CR90	HMF75	
			A2FE90			

- 减速机输入转向与输出转向相同,除表中所列传动比外,对有批量的产品传动比可以另选。
- Gearbox input direction is same to the output direction. Other ratio is optional.
- 该系列回转装置可根据用户需要选配不同形式的液压马达,并可根据实际工况组合各种功能阀块。
- Allowing fitted with different type motors and manifolds for relevant actual application.
- 根据应用场合不同,液压回转装置的使用选型也有所变化,详情请咨询本公司相关技术人员。
- Differently sized units and additional design variants can be furnished if requested.



## 外形尺寸

### Dimensions

IGH40T2-S1000

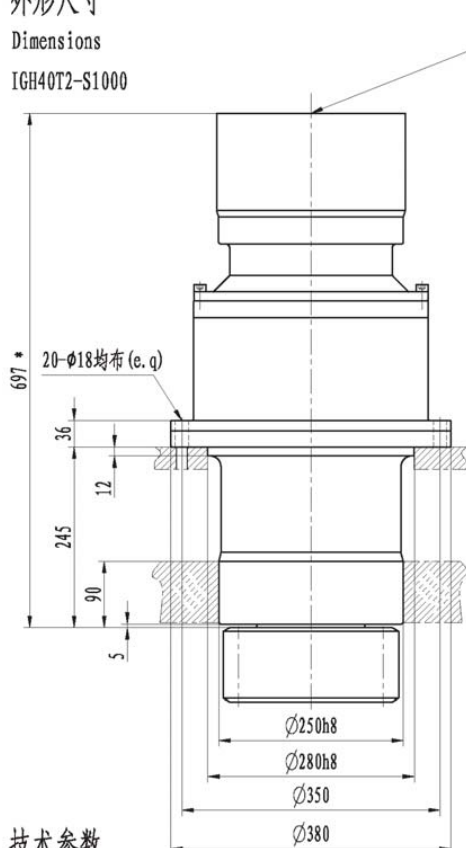

IGH40T2-S2000

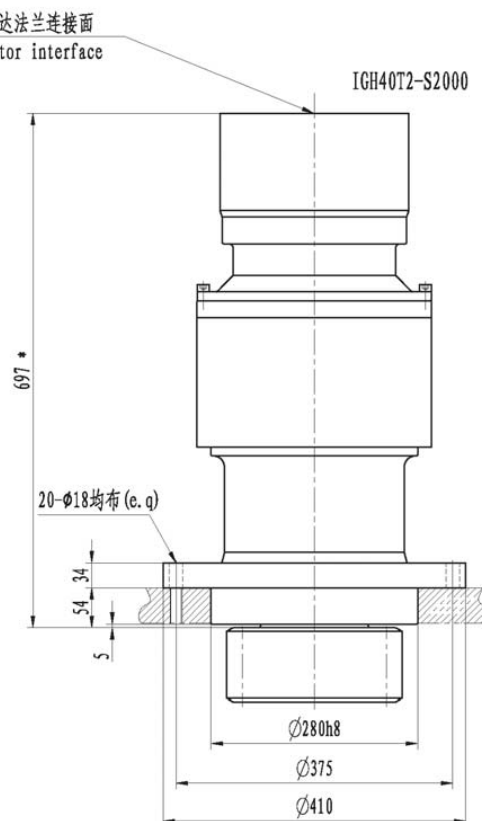

## 技术参数

### Technical Data

最大输出扭矩 Output Torque $T_{max}$ Nm	传动比 Ratio $i$	液压马达 Hydraulic Motor				重量 Weight ≈ kg
29000	36.9 · 42 · 49.3 · 60.1	A2FM55	A2FE63	H1CR55	HMF50	255
		A2FM63	A2FE80	H1CR75	HMF55	
		A2FM80	A2FE107	H1CR90	HMF75	
		A2FM107	A2FE125	H1CR108	HMF105	
<div>· 减速机输入转向与输出转向相同,除表中所列传动比外,对有批量的产品传动比可以另选。</div> <div>· Gearbox input direction is same to the output direction. Other ratio is optional.</div> <div>· 该系列回转装置可根据用户需要选配不同形式的液压马达,并可根据实际工况组合各种功能阀块。</div> <div>· Allowing fitted with different type motors and manifolds for relevant actual application.</div> <div>· 根据应用场合不同,液压回转装置的使用选型也有所变化,详情请咨询本公司相关技术人员。</div> <div>· Differently sized units and additional design variants can be furnished if requested.</div>						

## 外形尺寸

Dimensions

IGH60T3-S1000

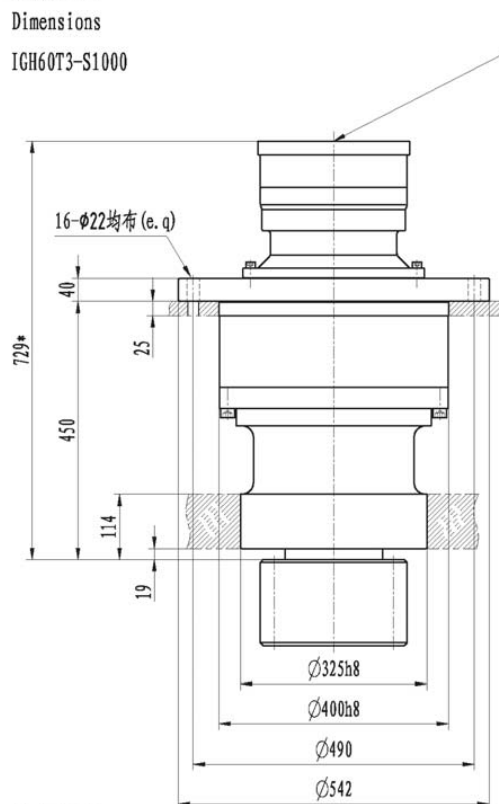

马达法兰连接面  
motor interface

IGH60T3-S2000

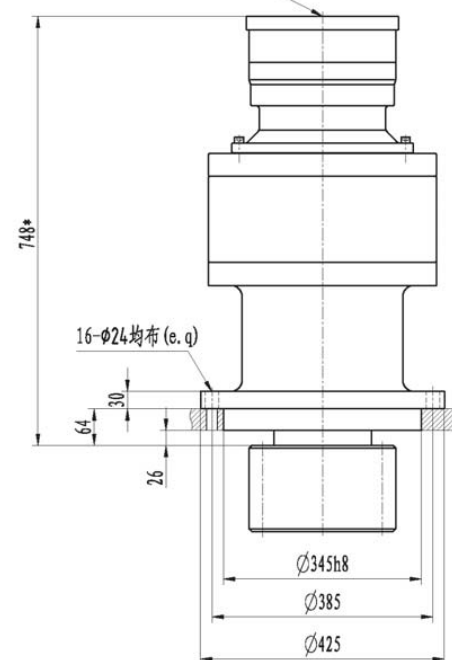

## 技术参数

Technical Data

最大输出扭矩 Output Torque $T_{max}$ Nm	传动比 Ratio $i$	液压马达 Hydraulic Motor				重量 Weight ≈ kg
48500	87.5 · 95.8 · 106.5 · 120.8 140.9 · 170.9	A2FM55 A2FM63 A2FM80	A2FE56 A2FE63 A2FE80 A2FE90	H1CR55 H1CR75 H1CR90	HMF55 HMF75 HMF105	500

- 减速机输入转向与输出转向相同,除表中所列传动比外,对有批量的产品传动比可以另选。
- Gearbox input direction is same to the output direction. Other ratio is optional.
- 该系列回转装置可根据用户需要选配不同形式的液压马达,并可根据实际工况组合各种功能阀块。
- Allowing fitted with different type motors and manifolds for relevant actual application.
- 根据应用场合不同,液压回转装置的使用选型也有所变化,详情请咨询本公司相关技术人员。
- Differently sized units and additional design variants can be furnished if requested.



外形尺寸

Dimensions

IGH80T3-S1000

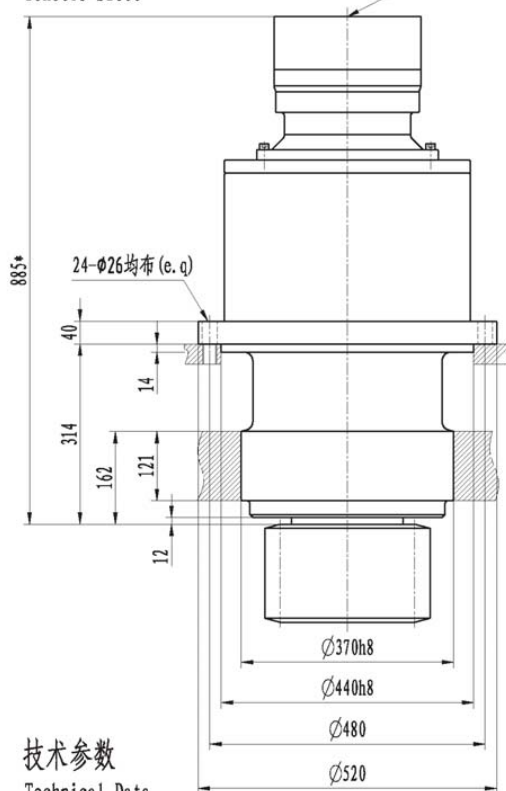

马达法兰连接面  
motor interface

IGH80T3-S2000

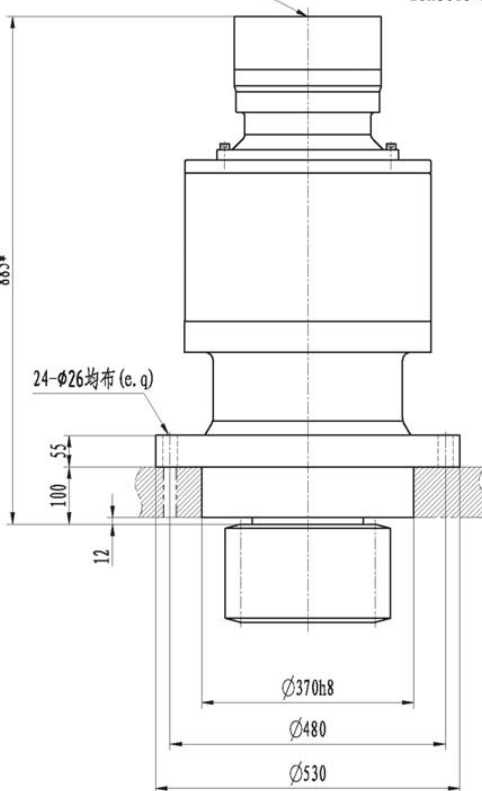

技术参数

Technical Data

最大输出扭矩 Output Torque $T_{max}$ Nm	传动比 Ratio $i$	液压马达 Hydraulic Motor				重量 Weight ≈ kg
68300	78.7 · 100 · 111.9 · 127.9 150.9 · 186.4	A2FM80 A2FM107 A2FM125	A2FE80 A2FE90 A2FE107 A2FE125	H1CR75 H1CR90 H1CR108	HMF75 HMF105 HMF135	620

- 减速机输入转向与输出转向相同,除表中所列传动比外,对有批量的产品传动比可以另选。
- Gearbox input direction is same to the output direction. Other ratio is optional.
- 该系列回转装置可根据用户需要选配不同形式的液压马达,并可根据实际工况组合各种功能阀块。
- Allowing fitted with different type motors and manifolds for relevant actual application.
- 根据应用场合不同,液压回转装置的使用选型也有所变化,详情请咨询本公司相关技术人员。
- Differently sized units and additional design variants can be furnished if requested.

## 外形尺寸

Dimensions

IGH80T3-S3000

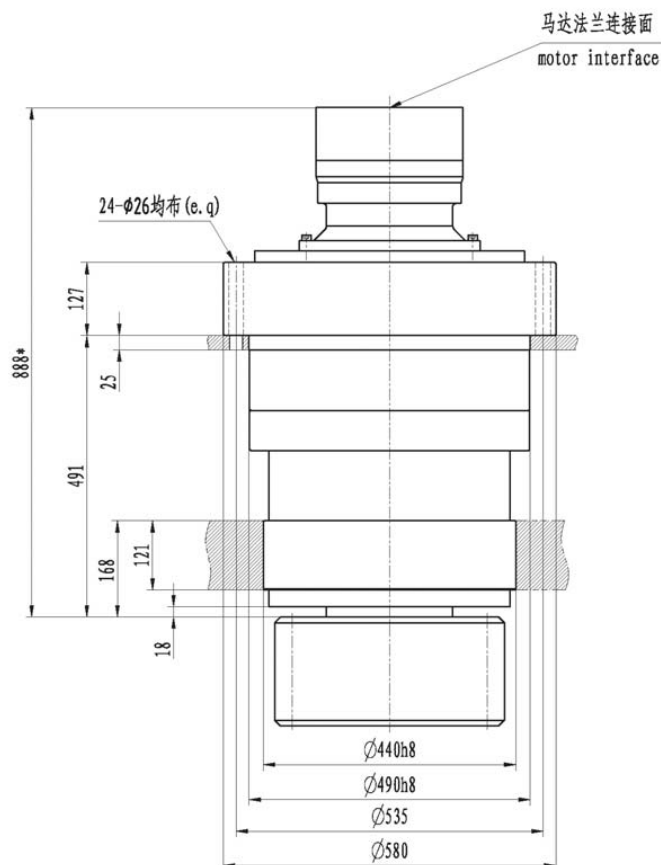

## 技术参数

Technical Data

最大输出扭矩 Output Torque $T_{max}$ Nm	传动比 Ratio $i$	液压马达 Hydraulic Motor				重量 Weight ≈ kg
68300	78.7 · 100 · 111.9 · 127.9 150.9 · 186.4	A2FM80 A2FM107 A2FM125	A2FE80 A2FE90 A2FE107 A2FE125	H1CR75 H1CR90 H1CR108	HMF75 HMF105 HMF135	635
<ul style="list-style-type: none"> <li>· 减速机输入转向与输出转向相同,除表中所列传动比外,对有批量的产品传动比可以另选。</li> <li>· Gearbox input direction is same to the output direction. Other ratio is optional.</li> <li>· 该系列回转装置可根据用户需要选配不同形式的液压马达,并可根据实际工况组合各种功能阀块。</li> <li>· Allowing fitted with different type motors and manifolds for relevant actual application.</li> <li>· 根据应用场合不同,液压回转装置的使用选型也有所变化,详情请咨询本公司相关技术人员。</li> <li>· Differently sized units and additional design variants can be furnished if requested.</li> </ul>						

# 外形尺寸

## Dimensions

IGH110T3-S1000

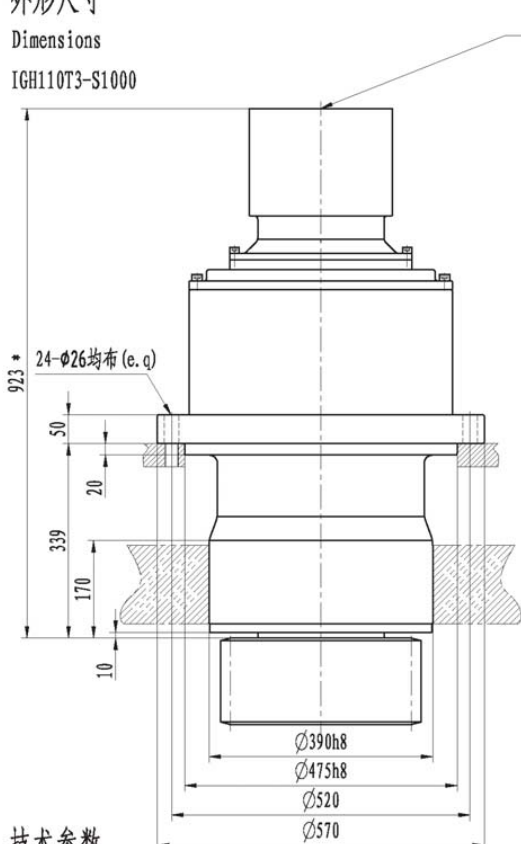

马达法兰连接面  
motor interface

IGH110T3-S2000

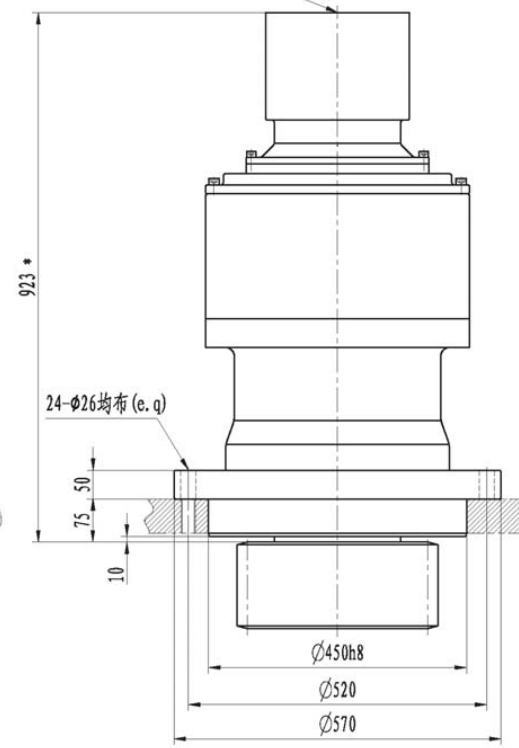

# 技术参数

## Technical Data

最大输出扭矩 Output Torque $T_{max}$ Nm	传动比 Ratio $i$	液压马达 Hydraulic Motor			重量 Weight ≈ kg
93300	96.8 · 115.8 · 129.6 · 148.2 174.9 · 216	A2FM125	A2FE107	HMF135	645
		A2FM160	A2FE125	HMF165	
		A2FM200	A2FE160	HMF210	
		A2FM250	A2FE180	HMF280	

- 减速机输入转向与输出转向相同, 除表中所列传动比外, 对有批量的产品传动比可以另选。
- Gearbox input direction is same to the output direction. Other ratio is optional.
- 该系列回转装置可根据用户需要选配不同形式的液压马达, 并可根据实际工况组合各种功能阀块。
- Allowing fitted with different type motors and manifolds for relevant actual application.
- 根据应用场合不同, 液压回转装置的使用选型也有所变化, 详情请咨询本公司相关技术人员。
- Differently sized units and additional design variants can be furnished if requested.

## 外形尺寸

Dimensions

IGH160T3-S1000

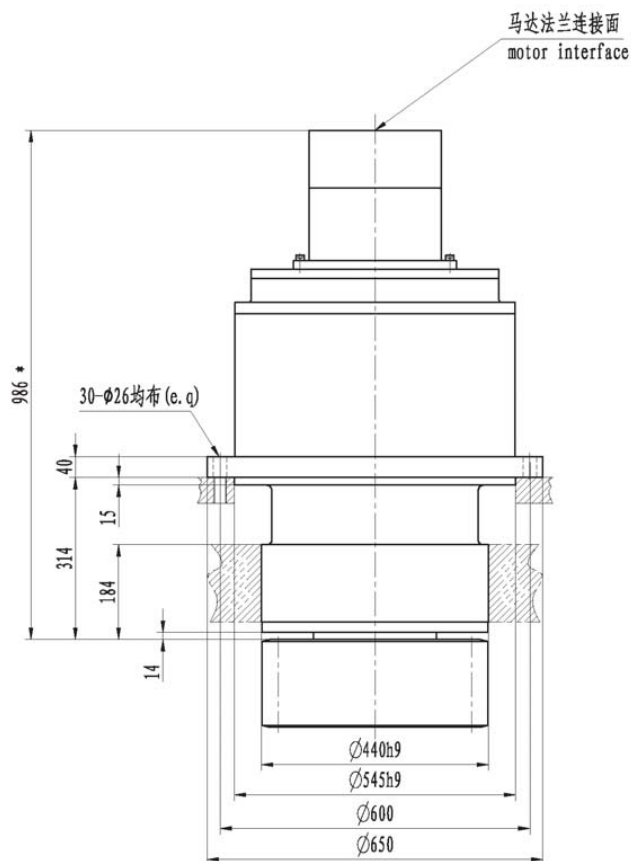

## 技术参数

Technical Data

最大输出扭矩 Output Torque $T_{max}$ Nm	传动比 Ratio $i$	液压马达 Hydraulic Motor			重量 Weight ≈ kg
136500	162.8 · 211.8 · 252	A2FM125 A2FM160 A2FM200 A2FM250	A2FE125 A2FE160 A2FE180	HMF165 HMF210 HMF280	1025
<ul style="list-style-type: none"> <li>· 减速机输入转向与输出转向相同,除表中所列传动比外,对有批量的产品传动比可以另选。</li> <li>· Gearbox input direction is same to the output direction. Other ratio is optional.</li> <li>· 该系列回转装置可根据用户需要选配不同形式的液压马达,并可根据实际工况组合各种功能阀块。</li> <li>· Allowing fitted with different type motors and manifolds for relevant actual application.</li> <li>· 根据应用场合不同,液压回转装置的使用选型也有所变化,详情请咨询本公司相关技术人员。</li> <li>· Differently sized units and additional design variants can be furnished if requested.</li> </ul>					

外形尺寸

Dimensions

IGH220T3-S1000

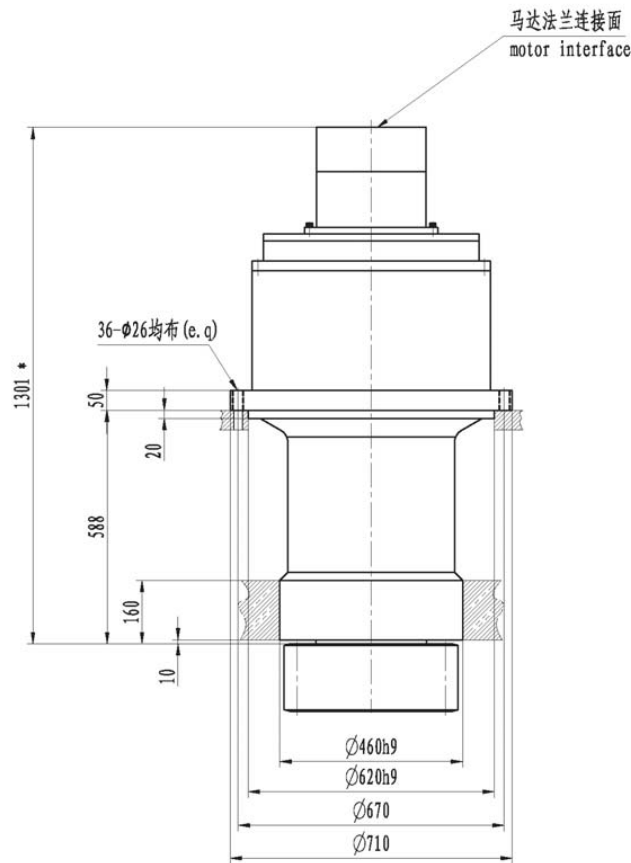

技术参数

Technical Data

最大输出扭矩 Output Torque $T_{max}$ Nm	传动比 Ratio $i$	液压马达 Hydraulic Motor			重量 Weight ≈ kg
213000	98.7 · 146.4 · 189.9 · 247 · 294	A2FM125 A2FM160 A2FM200 A2FM250	A2FE125 A2FE160 A2FE180	HMF165 HMF210 HMF280	1285
· 减速机输入转向与输出转向相同,除表中所列传动比外,对有批量的产品传动比可以另选。 · Gearbox input direction is same to the output direction. Other ratio is optional. · 该系列回转装置可根据用户需要选配不同形式的液压马达,并可根据实际工况组合各种功能阀块。 · Allowing fitted with different type motors and manifolds for relevant actual application. · 根据应用场合不同,液压回转装置的使用选型也有所变化,详情请咨询本公司相关技术人员。 · Differently sized units and additional design variants can be furnished if requested.					